

# SOPHIE'S STUDIO

Welcome Guide

Hi there,

I'm Sophie, and I'm so glad you've chosen my Athens studio for your stay!

I hope my apartment serves you well as a home away from home as you explore our beautiful city - please enjoy and make yourself comfortable.

Don't hesitate to reach out if you need anything.  
Welcome to Athens!

Best,

Sophie



## Useful information

WiFi Credentials	<b>ppo / efkolopassword</b>	
Emergency Number	You can call 112 from fixed and mobile phones to contact any emergency service: an ambulance, the fire brigade or the police.	
Athens Metro	The closest metro station is <b>Evangelismos</b> which is around 20' by foot.	
Buses	OASA line 4 stops 50m from the apartment and it's 8 stops away (about 20') from the Syntagma Square Metro station.	
Taxi	You can hail a Taxi on the street most hours of the day but there is a Taxi stop at <b>Pl. Nikolaou Plastira</b> , 500m away from the apartment where you can find a Taxi 24/7.	
Emergency Numbers	Ambulance <b>166</b> Fire Department <b>199</b> Police <b>100</b> Hospitals <b>106</b> Pharmacies <b>107</b>	
Useful apps & Sites	Athens Public Transport Free Now (Taxis) Athens International Airport Athens Guide	<a href="https://www.oasa.gr/en/">https://www.oasa.gr/en/</a> <a href="https://www.free-now.com/">https://www.free-now.com/</a> <a href="https://www.aia.gr/">https://www.aia.gr/</a> <a href="https://www.thisisathens.org/">https://www.thisisathens.org/</a>

## House Rules

1. No smoking
2. No pets
3. No parties or events
4. Respect the neighbors, keep noise down between 15:30 and 17:00 and between 23:00 and 07:00.
5. Make sure you turn off any hazardous electrical appliances like the oven, iron & kettle before leaving the house.

## Check-in & check-out times

We kindly request that guests adhere to our check-in time starting at **14:00** and check-out by **12:00**. Your cooperation in adhering to these times would be greatly appreciated. Should you require a late check-out, please reach out to me. Note however that due to potential same-day check-ins, we may not always be able to accommodate late checkout requests. Your understanding in this matter is greatly appreciated.

## Check-in process

The exterior doors of the building are WiFi operated, you can **press the apartment buzzer** and we will let you in wirelessly. See the diagram on the right for the correct buzzer button to press.

The apartment is on the 6th floor, once there you can find a **lockbox** for your keys right beside the apartment door. You will receive a code for the lockbox at least 48 hours before check in. The keychain contains 2 keys, one key opens the apartment and the other opens the exterior doors.

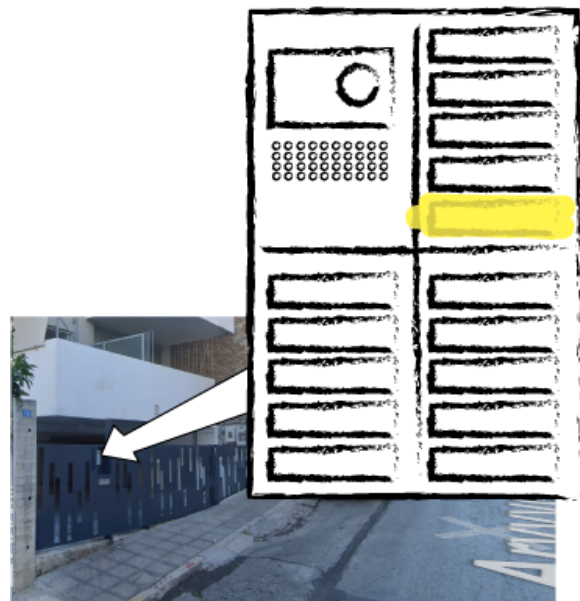

## Check-out process

While checking out please make sure you haven't left any of your belongings behind. You can leave the keys inside the apartment and close the door.

## Parking Space

The apartment has a private parking space that is available to guests. You can find the garage door key fob next to the tv.

## Emergencies

There is a **first aid kit** under the living room table. There is a **fire blanket** and a **fire extinguisher** under the kitchen sink.

## Operating the hot water boiler

To operate the boiler please find the electrical panel on the right of the bathroom door. The boiler button is on the bottom right. Pressing the button will turn on the boiler for 30' or until the boiler is done heating the water. The boiler is located inside the bathroom, there is a gauge on it that shows how much hot water is left. A full boiler is enough for 3 to 4 showers.

## Cleaning supplies

You can find a vacuum cleaner in the leftmost closet door in the bedroom. There's ironing equipment in the rightmost closet door. Cleaning supplies are located under the kitchen sink and you can also find detergents for the washing machine under the bathroom sink.

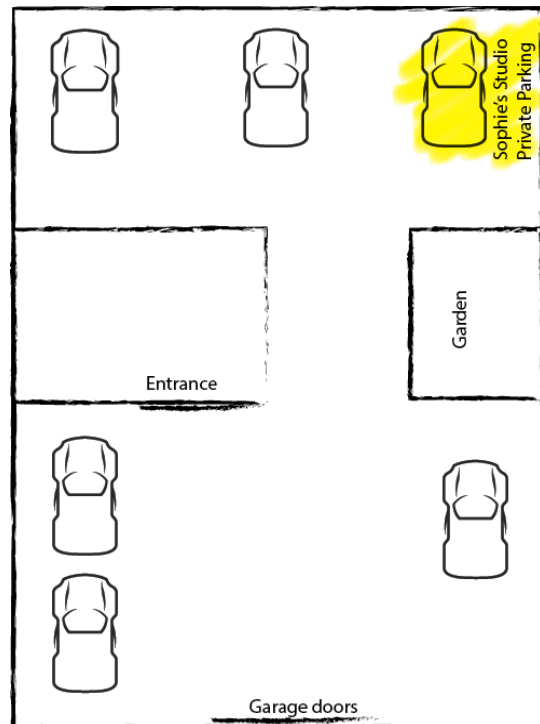

## Places to eat

Pangrati is one of the trendiest neighborhoods of Athens. The apartment is located within walking distance of 2 Michelin star restaurants and numerous other cafes, bars and restaurants. Whether going out for brunch or dinner or just a coffee you will be spoilt for choice. Here's some recommendations to get you started.

### Fine dining

#### Soil

One of Athens' new Michelin-starred restaurants, offers a special yet unpretentious dining experience with a focus on Athenian authenticity.

*5 Ferekidou, Pangrati, 116 35*

<https://soilrestaurant.gr/>

#### Spondi

Athens' first Michelin-starred restaurant since 2002, offers sophisticated French cuisine in a relaxed environment.

*5 Pyrronos, Pangrati, 116 36*

<https://www.spondi.gr/en/>

### Brunch

#### Monsieur cannibale

A stylish brasserie offering amazing cocktails and great brunch options.

*Pl. Profitou Ilia 2, Pangrati 116 35*

<https://www.instagram.com/mon.cannibale/>

#### The Blind Spot

Freshly baked bagels and artisanal coffee.

*Efranoros 22, Pangrati 116 35*

<https://www.theblindspot.gr/>

### Local Cuisine

#### Mouries

Traditional Taverna restaurant with a huge range of greek dishes.

*Pl. Varnava, Pangrati, 11635*

<https://www.mouries.com.gr/>

#### Mavro Provato

Greek dishes with a modern spin.

*Arrianou 33, Pangrati 116 35*

<https://tomauprovato.gr>

## Things to do

### **Kallimarmaro**

Kallimarmaro, also known as the Panathenaic Stadium, is an ancient stadium located in Athens, Greece, made entirely of marble. Renowned for hosting the first modern Olympic Games in 1896. **Avoid the main entrance** and visit through the back entrance that leads to the hill surrounding the stadium for a majestic view of the site. Access to the hill is free.

Archimidous 15 , Pagkrari, 116 35

### **Goulandris Museum of Modern Art**

Basil and Elise Goulandris Foundation's extensive collection of Impressionist, Modernist, and post-war art, situated conveniently in Pangrati, features a priceless collection showcasing works by iconic artists such as Cézanne, Van Gogh, and Picasso.

*Eratosthenous 13, Athina 116 35*